

# Focus Enterprise



**ENMOS**  
SIMPLICITY SMART

## Central Monitoring and Management

[info@enmos.com](mailto:info@enmos.com)

### Focus Central Monitoring and Management Software



# Focus Software (Central Monitoring & Management)

## Real Costs Calculation

Basic level of real costs calculation begins with data collection. Because your decision has low chance of success without real-time data. How do you understand if the price you have given to your customers is profitable? You are very late if you understand by looking at the year end balance. You can lose your chance to complete before year ends.

## Controlled Repeatability

The most important problem at dyeing process is repeatability because of inputs required for every dyeing process is different from one another. Enmos's turnkey dyehouse automation solution always ensure you get the same result by dyeing affected minimum of these changes.

## Monitoring and Reporting

For meaningful data collection, report should be prepared in suitable formats. The reports about starting and ending times, capacity utilization, alarm status, consumer information, total elapsed time, will provide you detailed information about your company and also you can take improvements and measures at your business processes.

## Data Collection

Increasing productivity and reduction of costs begin with data collection. Because without having a systematic information about errors and delays in company, increasing productivity and reduction of costs are hard. Due to the data collection, you can watch and manage the all process details.

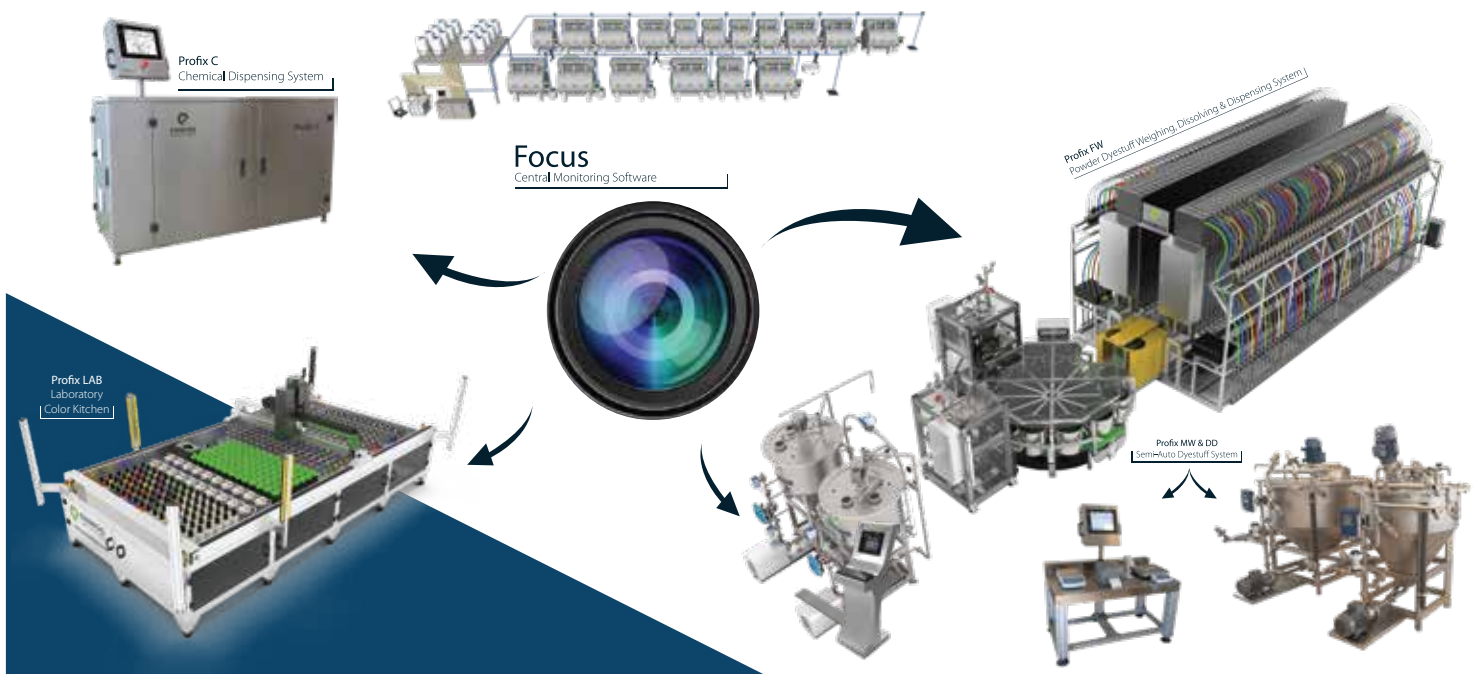

## Increasing Productivity and Minimize Errors

To be presented the data collected suitable reports and online monitoring, will help your decisions for increasing productivity and minimize errors. To give fast an accurate decisions will be possible with collected data by applicable operations. You will see how applied operations increase productivity and what cause errors is in a very short time. Due to Enmos's fully automatic dyeing computers, the most of operations that require human intervention is not needed. So productive losses by caused human mistake can prevent.

## User Friendly

Due to Focus' user friendly interface, user can manage and monitor whole system easily.

## Database

Focus' relation database structure is designed for microsoft MS SQL SERVER 2005

## Central Monitoring and Management Software

Focus is a software solution for dyehouses, based on client/server architecture with secure multi-user database. It can be integrated into your plant's existing system and provides via remote access technical service and maintenance which reduces time and costs to a minimum. . With its connection with chemical automation, salt-soda or dyestuff system your machines can transfer chemical needs in real-time.

### Why Dyehouse Automation?

Manufacturers can not determine increasing global competition, sales price correspondingly changing, raw material, labor and energy costs. 'Calculate and reduce the actual costs, increase production productivity, to minimize the margin of error, controlled repeatability, planning, full control and tracking' are the most important factors that may affect competitiveness and profitability of a company. All of the factors that make a company profitable in a strong competitive environment are possible by the systematic and accurate implementation of the following items.

- Data collection
- Minimize errors
- Monitoring and reporting
- Increasing productivity
- Real cost calculation
- Reduction of costs
- Feasibility

### Monitoring Module

Monitoring Module machines dependent on system quickly. It is possible to monitor the working or completed batch , on the selected machine in detail. You can monitor the alarms in the machine, manual operations, temperature / time graph in detail by using the monitoring editor.

### Recipe Module

You can define necessary chemicals and other materials for dyeing and you can get recipe report. At the same time the recipe module is able to work integrated to chemical automation system, therefore it quickly meets chemical demands of machines on system.

### Machine Module

You can define every machine that are installed in the dyehouse and create groups depend on machine's specifications.

### Remote Monitoring Support

You can monitor your dyehouse online and easily get the reports that you need. So you always have the chance to keep your company under control and see the efficiency online.

### Program Editor

You can create your dyeing programs according to the specifications of your machines and receipts, also transfer the programs to defined dyeing computers. This feature allows you to remotely write a program that you have previously written for all computers without having to write it separately.

### Planning Module

You can plan the operation of your machines in advance and thus increase productivity. Due to the real-time connection, planning can change automatically according to a program's actual status and these changes are indicated by a different color. Planning module uses horizontal time axis table that makes understanding the plan easier and visualises possible deflections.

### Consumption Module

You can get the consumption data of a completed batch recipe. Thus, you can get consumption report of volume of each materials in recipe such as chemicals, electricity, steam, water etc. After that you can calculate your real costs of each recipe.

### Reporting Module

You can easily get the reports of the processes that you need. You can try new report formats or personalize existing ones like fullness and capacity reports of machines, operator reports, warning reports, consumption reports etc.



# Focus VT (Data Collecting)

Whichever industry you work in, or whatever your interests, you will almost certainly have come across a story about how “data” is changing the face of our world. It might be part of a study helping to cure a disease, boost a company’s revenue, make a building more efficient or be responsible for those targeted ads you keep seeing.

In general, data is simply another word for information. Data refers to information that is machine-readable as opposed to human-readable.

Data collection is the process of gathering and measuring data, information or any variables of interest in a standardized form. Data collection is concerned with the accurate acquisition of data; although methods may differ depending on the field, the emphasis on ensuring accuracy remains the same.

Through Focus VT, you may collect real data as shown below from machine, or machine station.

- Temperature
- Steam
- Electricity
- Water
- Humidity
- Pressure
- Cycle Period

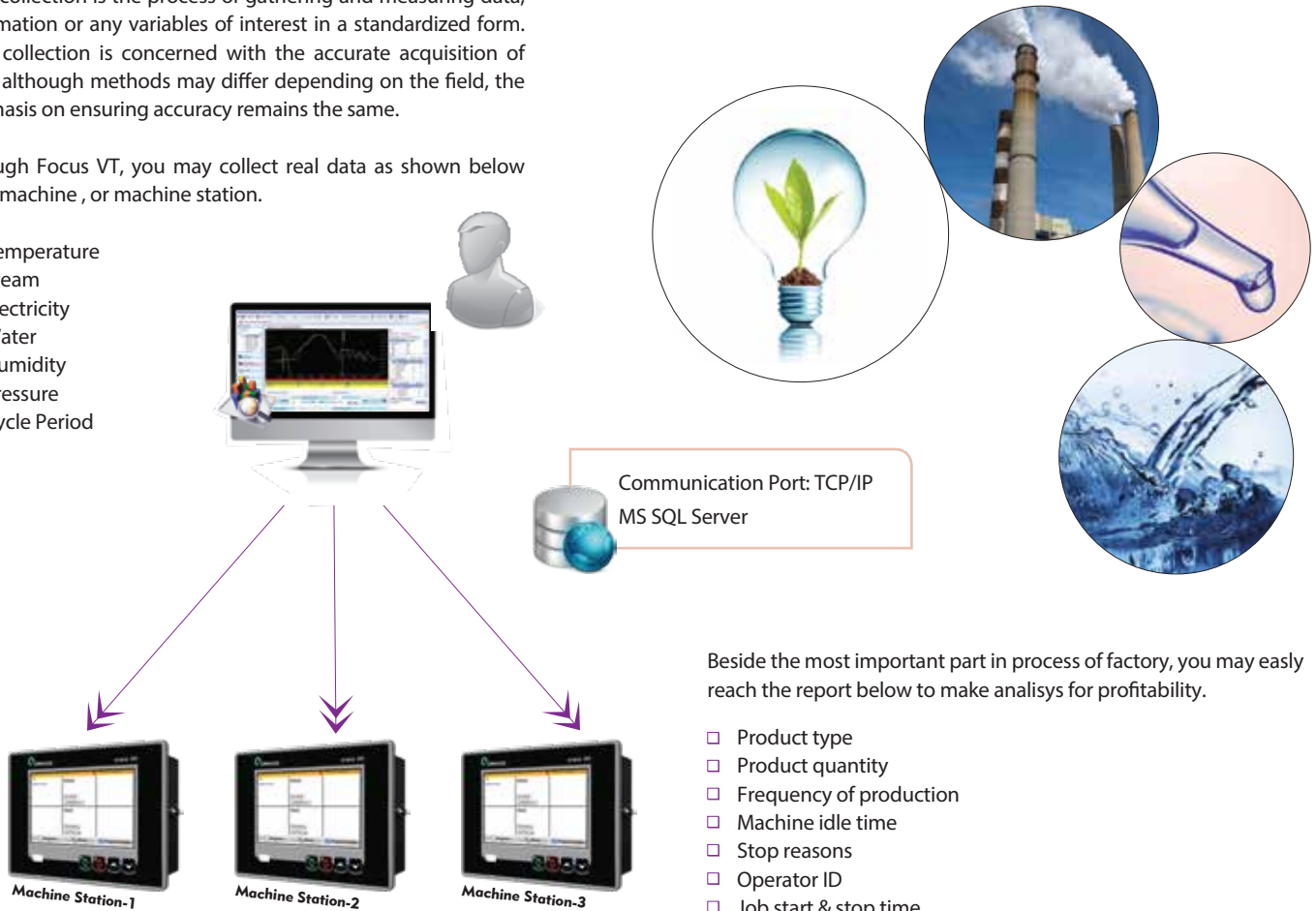

Beside the most important part in process of factory, you may easily reach the report below to make analysis for profitability.

- Product type
- Product quantity
- Frequency of production
- Machine idle time
- Stop reasons
- Operator ID
- Job start & stop time

The primary goal of any data collection endeavor is to capture quality data or evidence that easily translates to rich data analysis that may lead to credible and conclusive answers to questions that have been posed.

